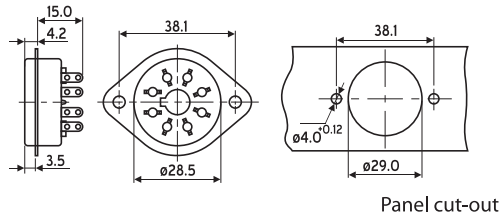
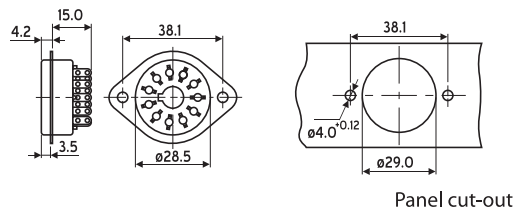

**Chassis mounting relay sockets**

Ordering code

**CMS 08**  
 (8 Pin socket)

Ordering code

**CMS 11**  
 (11 Pin socket)

Standard conformity	EN 60947-5-1 IEC 947-5-1
Material	Bakelite
Colour	Black
Rating	10A AC/DC, 240V rms.
Dielectric strength	1500V AC rms. for 1 minute
Insulation resistance	1000Mohms min. at 500V DC
Temperature range	-45°C to +120°C
Mounting	Front / rear with two M4 screws
Terminals	Solder

All dimensions are in mm.  
 Due to continuous improvement in products, we reserve the right to alter specifications without prior notice