

ILLUMINATED PUSH BUTTON (LED TYPE)

FLUSH TYPE

Type	Description	Ordering code
A	Actuator	PB5-EW3()
B	Actuator with Plastic Bracket	PCB5-EW3()
C	Actuator with Plastic Bracket & LED Holder with LED	PCB5-EWL3()6 #
D	Actuator with Plastic Bracket & LED Holder with LED and Contact Block	PCB5-EWL3()6* #

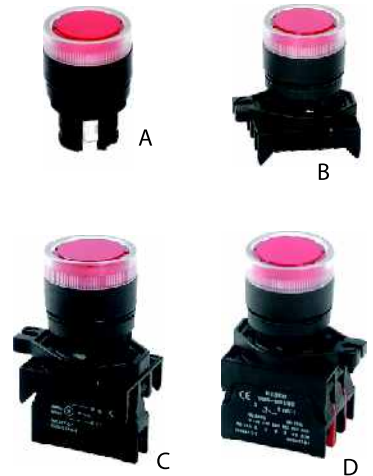
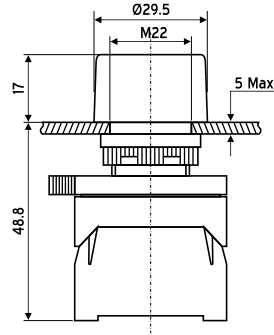

PROJECTING TYPE

Type	Description	Ordering code
A	Actuator	PB5-EWL3()
B	Actuator with Plastic Bracket	PCB5-EWL3()
C	Actuator with Plastic Bracket & LED Holder with LED	PCB5-EWLL3()6 #
D	Actuator with Plastic Bracket & LED Holder with LED and Contact Block	PCB5-EWLL3()6* #

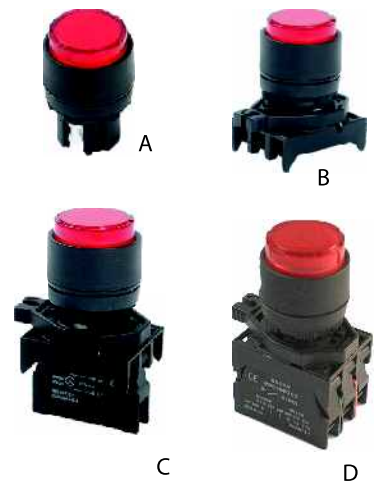
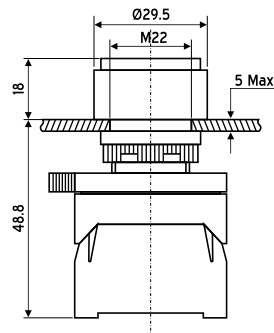

SELECTOR SWITCHES 2 POSITION - STAY PUT

Type	Description	Ordering code
A	Actuator	PB5-EK2()
B	Actuator with Plastic Bracket	PCB5-EK2()
C	Actuator with Plastic Bracket & LED Holder with LED	PCB5-EKL2()6 #
D	Actuator with Plastic Bracket & LED Holder with LED and Contact Block	PCB5-EKL2()6* #

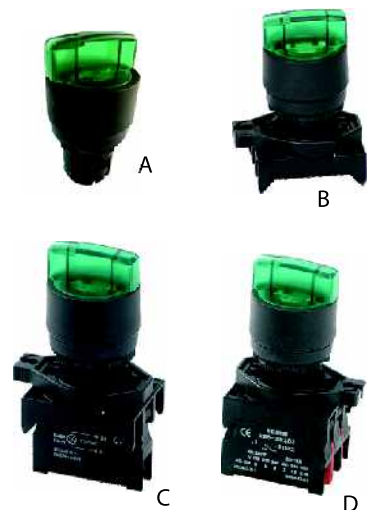
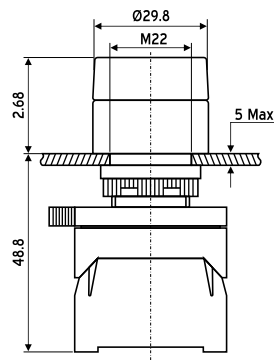

Note : Please mention operating voltage while ordering illuminated push buttons

Add following suffixes in the ordering code of push button switches for colour & voltage contact blocks.

() 1 = White, 3 = Green, 4 = Red, 5 = Yellow, 6 = Blue

* 1 = NO contact, 2 = NC contact, 3 = NO+NO, 4 = NC+NC, 5 = NO+NC A = 2NO+NC B = NO+2NC C = 2NO+2NC

24, 110, 220 V AC & 24, 110, 220 V DC

^ For Push to On & Push to Off Actuator in Flush and Projecting type, Add 'Z' after 'W' in Flush type e.g. PB5-EWZ3() and after 'L' in Projecting type e.g. PB5-EWLZ3()

2 POSITION - SPRING RETURN FROM RIGHT TO LEFT

Type	Description	Ordering code
A	Actuator	PB5-EKR2()
B	Actuator with Plastic Bracket	PCB5-EKR2()
C	Actuator with Plastic Bracket & LED Holder with LED	PCB5-EKLR2()6 #
D	Actuator with Plastic Bracket & LED Holder with LED and Contact Block	PCB5-EKLR2()6* #

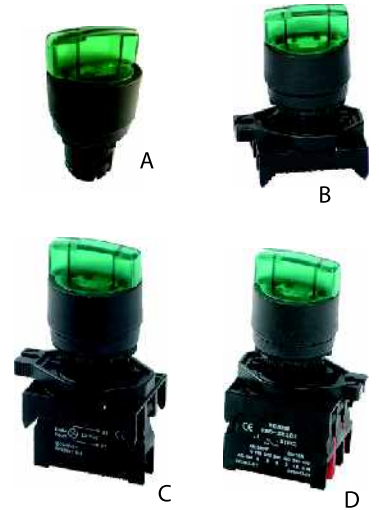
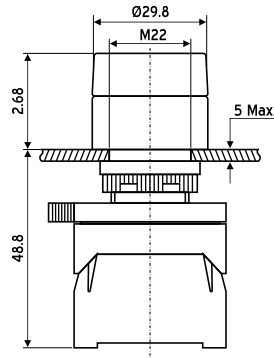

3 POSITION - STAY PUT

Type	Description	Ordering code
A	Actuator	PB5-EK3()
B	Actuator with Plastic Bracket	PCB5-EK3()
C	Actuator with Plastic Bracket & LED Holder with LED	PCB5-EKL3()6 #
D	Actuator with Plastic Bracket & LED Holder with LED and Contact Block	PCB5-EKL3()6* #

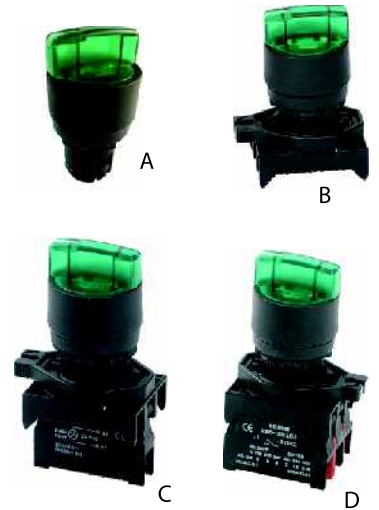
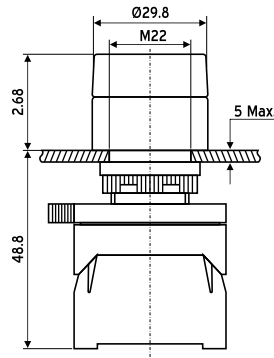

3 POSITION - SPRING RETURN FROM BOTH POSITION TO CENTRE

Type	Description	Ordering code
A	Actuator	PB5-EKR3()
B	Actuator with Plastic Bracket	PCB5-EKR3()
C	Actuator with Plastic Bracket & LED Holder with LED	PCB5-EKLR3()6 #
D	Actuator with Plastic Bracket & LED Holder with LED and Contact Block	PCB5-EKLR3()6* #

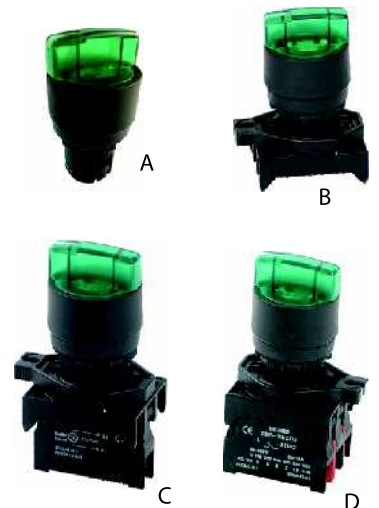
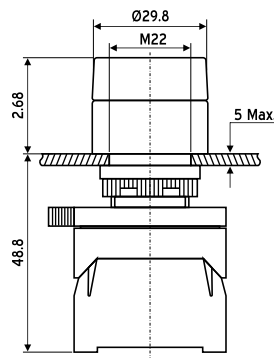

Note : Please mention operating voltage while ordering illuminated push buttons

Add following suffixes in the ordering code of push button switches for colour & voltage contact blocks.

() 1 = White, 3 = Green, 4 = Red, 5 = Yellow, 6 = Blue

* 1 = NO contact, 2 = NC contact, 3 = NO+NO, 4 = NC+NC, 5 = NO+NC A = 2NO+NC B = NO+2NC C = 2NO+2NC

24, 110, 220 V AC & 24, 110, 220 V DC