

- Characteristics
- Excellent illumination
 - Long life
 - Available with surge protection
 - Low current consumption
 - Incorporates solid-state devices
 - Shock proof and vibration resistant
 - Modular in construction
 - Capable of withstanding wide voltage variations
 - Highly polished smooth lens
 - Compact in size and are available for direct connection upto 415V AC Supply
 - Available in Red, Green, Yellow, White, Amber and Blue colour lens with diffuser
 - Provided with a shroud to cover terminals. Shroud is detachable to facilitate termination through lugs
 - Available with LVGP (Low Voltage Glow Protection)
 - Flasher LED module are available for visibility from large distance
 - Bi colour or tri colour modules for multiple status indication in single package
 - Confirm to IEC 60497-1

Without LVGP			
Ordering code	Voltage		
SLM1()	24V	AC	24V AC
SLM1()	48V	AC	48V AC
SLM1()	110V	AC	110V AC
SLM1()	220V	AC	220V AC
SLM1()	415V	AC	415V AC
SLM1()	12V	DC	12V DC
SLM1()	24V	DC	24V DC
SLM1()	48V	DC	48V DC
SLM1()	110V	DC	110V DC
SLM1()	220V	DC	220V DC
SLM1()	M	Multivoltage (24- 220V AC / DC)	

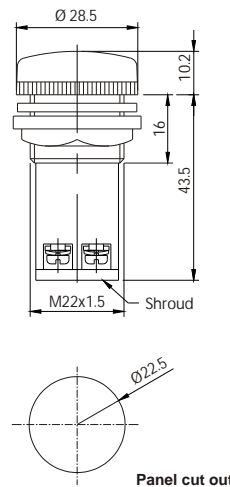

TECHNICAL DATA

Current	10mA to 15mA (voltage dependant)
Voltage	24, 48, 110, 220, 415 V AC 12, 24, 48, 110, 220 V DC Multi voltage 24 - 220 V AC/DC
Voltage variation	±20% of operating voltage
Led forward voltage drop	2 V approx
Max reverse voltage(PIV)	5V
Intensity	60 mcd luminus intensity
Maximum power dissipation	3VA (AC), 2W (DC)
Viewing angle	160 degree
Insulation resistance	> 500 Mohms
Dielectric test voltage	2.5 KVAC for 1 minute
Ambient temperature	-20°C to + 75°C
Available colour	Red, Green, Yellow, Amber, White and Blue
Bezel colour	Off-White
Material	Thermoplastic (UL 94VO) with smooth polycarbonate lens
Terminal	M3 screw with captive washer
Cut-out required	22.5 mm. dia
Ingress protection	IP20 (rear), IP65 (front)

All dimensions are in mm.
Due to continuous improvement in products, we reserve the right to alter specifications without prior notice

With LVGP
(Low Voltage Glow Protection)

Ordering code	Voltage		
SLM1() L	24V	AC	24V AC
SLM1() L	48V	AC	48V AC
SLM1() L	110V	AC	110V AC
SLM1() L	220V	AC	220V AC
SLM1() L	12V	DC	12V DC
SLM1() L	24V	DC	24V DC
SLM1() L	48V	DC	48V DC
SLM1() L	110V	DC	110V DC
SLM1() L	220V	DC	220V DC

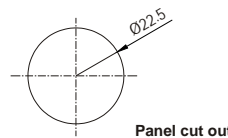
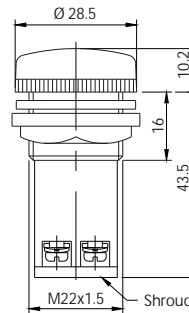

415VAC & Multi voltage LED module pilot lights do not have LVGP facility

With surge protection

Ordering code	Voltage		
SLM1() S	24V	AC	24V AC
SLM1() S	48V	AC	48V AC
SLM1() S	110V	AC	110V AC
SLM1() S	220V	AC	220V AC
SLM1() S	415V	AC	415V AC
SLM1() S	12V	DC	12V DC
SLM1() S	24V	DC	24V DC
SLM1() S	48V	DC	48V DC
SLM1() S	110V	DC	110V DC
SLM1() S	220V	DC	220V DC

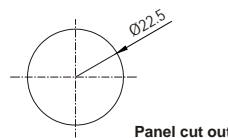
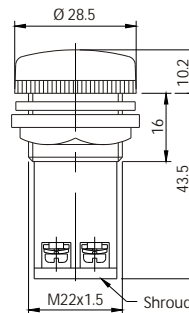

() Colour : Red - R, Green - G, Amber - A, Blue - B, Yellow - Y, White - W

ADAPTOR PLATES

Material	Steel
Plating	Nickel
Ordering code	'AD25' suitable for 25.5 mm. cut-out. 'AD30' suitable for 30.5 mm. cut-out. 'AD45' suitable for 45 mm. cut-out. Other sizes on request.



All dimensions are in mm.
Due to continuous improvement in products, we reserve the right to alter specifications without prior notice

Bi colour

Ordering code	Voltage	
SLM 2() 24V AC	AC	24V AC
SLM 2() 48V AC	AC	48V AC
SLM 2() 110V AC	AC	110V AC
SLM 2() 220V AC	AC	220V AC
SLM 2() 12V DC	DC	12V DC
SLM 2() 24V DC	DC	24V DC
SLM 2() 48V DC	DC	48V DC
SLM 2() 110V DC	DC	110V DC
SLM 2() 220V DC	DC	220V DC

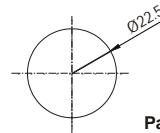
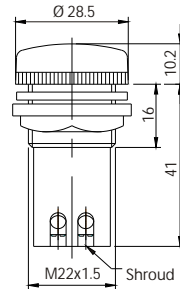

Panel cut out

() Colour : RG - Red & Green,
 AG - Amber & Green,
 RA - Red & Amber,

Tri colour

Ordering code	Voltage	
SLM 3() 24V AC	AC	24V AC
SLM 3() 48V AC	AC	48V AC
SLM 3() 110V AC	AC	110V AC
SLM 3() 220V AC	AC	220V AC
SLM 3() 12V DC	DC	12V DC
SLM 3() 24V DC	DC	24V DC
SLM 3() 48V DC	DC	48V DC
SLM 3() 110V DC	DC	110V DC
SLM 3() 220V DC	DC	220V DC

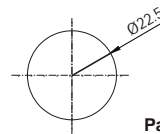
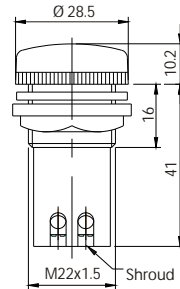

Panel cut out

() Colour : RAG - Red, Amber & Green
 RAG - Red, Amber & Blue

Bi colour & Tri colour LED module pilot lights are available in water clear lens only.

All dimensions are in mm.
 Due to continuous improvement in products, we reserve the right to alter specifications without prior notice

Flasher LED

Ordering code	Voltage		
SLM 4()	24V	AC	24V AC
SLM 4()	48V	AC	48V AC
SLM 4()	110V	AC	110V AC
SLM 4()	220V	AC	220V AC
SLM 4()	12V	DC	12V DC
SLM 4()	24V	DC	24V DC
SLM 4()	48V	DC	48V DC
SLM 4()	110V	DC	110V DC
SLM 4()	220V	DC	220V DC

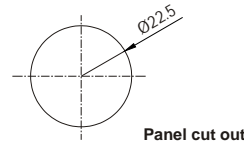
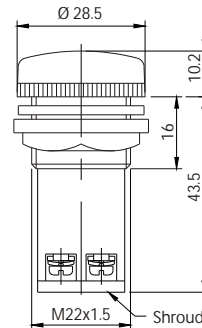

() Colour : R - Red, G - Green, A - Amber, Y - Yellow

Ordering code

Series	Function	Colour	With LVGP	Voltage
SLM	1	R	L	220 VAC
	1 : Single LED	R - Red	Omitted : Without LVGP	24, 48, 110, 220, 415 VAC
	2 : Bi colour	G - Green	L : With LVGP	12, 24, 48, 110, 220 VDC
	3 : Tri colour	A - Amber	S : With Surge Protection	M : Multi Voltage (24 - 220 V AC /DC)
	4 : Flasher	B - Blue Y - Yellow W - White		

- Note :
1. For Bi colour and Tri colour LED module pilot lights are available only in water clear lens.
 2. Bi colour module is available in combination of Red Green and Amber colours and Tri- colour in Red- Green- Amber colours.
 3. Bi colour, Tri colour & flasher LED module pilot lights are not available with 415V AC & multivoltage.