

MUSHROOM HEAD (Ø 40 mm.)

Type	Description	Ordering code
A	Actuator Red	PB5-EC4
B	Actuator & plastic bracket	PCB5-EC4
C	Actuator, plastic bracket & contact block	PCB5-EC4*

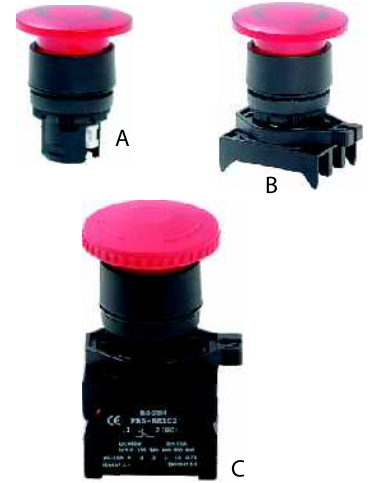
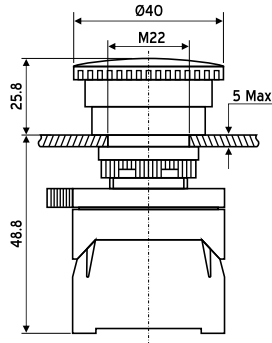

Note : Mushroom head (Ø 40 mm.) push button switches are available in Red, Green & Black colours only.

LATCHING MUSHROOM HEAD (Ø 40 mm.) (Emergency stop push button)

PRESS TO LOCK, TURN TO RELEASE

Type	Description	Ordering code
A	Actuator Red	PB5-ES 54
B	Actuator & plastic bracket	PCB5-ES 54
C	Actuator, plastic bracket & contact block	PCB5-ES 54*

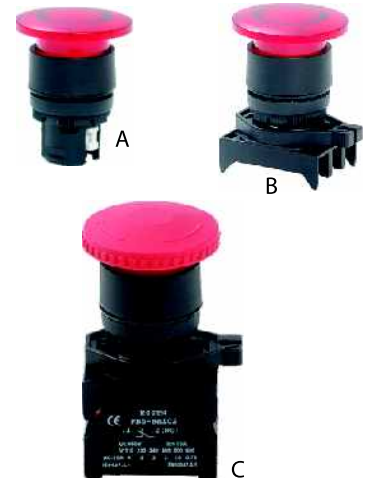
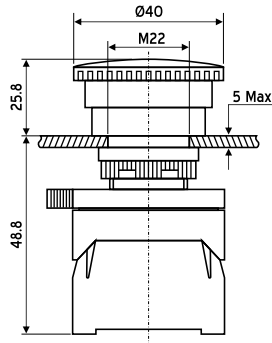

Note : Emergency stop Mushroom push button switches are available in Red & Black colours only.
Add suffix 'E' in the ordering code of Emergency stop push button switch for marking 'E STOP' on actuator.

MUSHROOM HEAD (Ø 40 mm.) (Push - Pull)

Type	Description	Ordering code
A	Actuator	PB5-ET()
B	Actuator & plastic bracket	PCB5-ET()
C	Actuator, plastic bracket & contact block	PCB5-ET()*

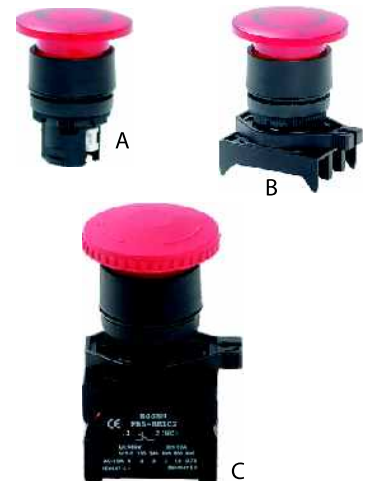
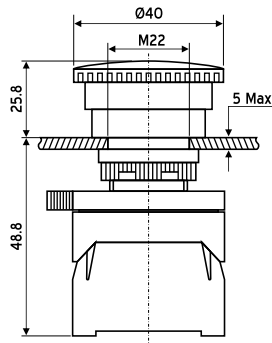

Note : Emergency stop Mushroom push button switches are available in Red & Black colours only.
Add suffix 'E' in the ordering code of Emergency stop push button switch for marking 'E STOP' on actuator.

Add following suffixes in the ordering code of push button switches for colour and contact blocks.

() 1 = White, 2 = Black, 3 = Green, 4 = Red, 5 = Yellow, 6 = Blue

* 1 = NO contact, 2 = NC contact, 3 = NO+NO, 4 = NC+NC, 5 = NO+NC A = 2NO+NC B = NO+2NC C = 2NO+2NC