

- Characteristics
- Aesthetically elegant
  - Self wiping contacts ensure trouble free operation
  - Safe in operation, locking device unaffected by vibration
  - Protection against electrical shock (unit earthed)
  - Shrouded terminals
  - Modular construction
  - Conform to IEC/EN-60947-5-1



### SPRING RETURN PUSH BUTTON SWITCHES

#### FLUSH TYPE

| Type | Description                               | Ordering code      |
|------|---|--------------------|
| A    | Actuator                                  | <b>PB5-EA( )</b>   |
| B    | Actuator & plastic bracket                | <b>PCB5-EA( )</b>  |
| C    | Actuator, plastic bracket & contact block | <b>PCB5-EA( )*</b> |

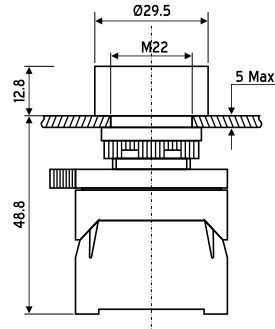

#### PROJECTING TYPE

| Type | Description                               | Ordering code      |
|------|---|--------------------|
| A    | Actuator                                  | <b>PB5-EL( )</b>   |
| B    | Actuator & plastic bracket                | <b>PCB5-EL( )</b>  |
| C    | Actuator, plastic bracket & contact block | <b>PCB5-EL( )*</b> |

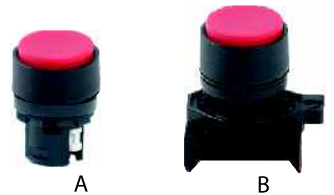
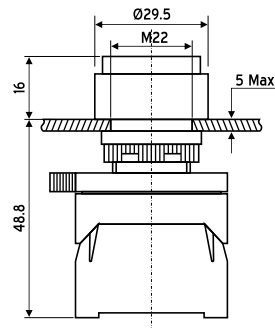

#### BOOTED TYPE

| Type | Description                               | Ordering code      |
|------|---|--------------------|
| A    | Actuator                                  | <b>PB5-EP( )</b>   |
| B    | Actuator & plastic bracket                | <b>PCB5-EP( )</b>  |
| C    | Actuator, plastic bracket & contact block | <b>PCB5-EP( )*</b> |

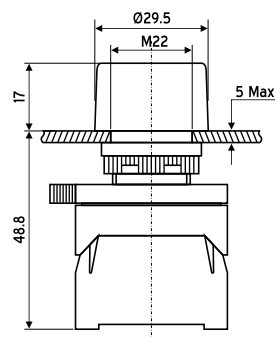

Add following suffixes in the ordering code of push button switches for colour and contact blocks.

( ) 1 = White, 2 = Black, 3 = Green, 4 = Red, 5 = Yellow, 6 = Blue

\* 1 = NO contact, 2 = NC contact, 3 = NO+NO, 4 = NC+NC, 5 = NO+NC A = 2NO+NC B = NO+2NC C = 2NO+2NC